

Motor Table and Control Replacement Kits for 24 and 25 Series Steps

! Before attempting any electric step assembly repair work, please read all of the following instructions.

Disconnect the power at the vehicle battery once the step is extended.

Motor Table

Instructions for removing and replacing the motor table.

1. Remove 3/8 nut (*Item 1*) connecting drive linkage (*Item 2*) to motor table stud.
2. Slide drive linkage off of motor table stud and rotate out of the way.
3. Remove four bolts and lock washers (*Items 3 and 4*) from motor table (*Item 5*).
4. Disconnect motor electrical connector from motor.
5. Remove motor table.
6. Place new motor table on step. Install and tighten 4 bolts and lock washers (*Items 3 and 4*). (*Note: Leave the two bolts in the slotted holes loose if installing new control. See Figure 1.*)
7. Slide drive linkage (*Item 2*) over motor table stud and install 3/8 nut (*Item 1*) and tighten.
8. Connect electrical connector to motor, unless replacing control.

Control Unit

Instructions for removing and replacing the control unit.

1. Remove 4 screws (*Item 6*) holding control (*Item 7*) and control short green ground wire to step.
2. Disconnect 4 way Packard connector from coach wiring.

Refer to Figure 1 for item numbers referenced in these instructions.

FIGURE 1

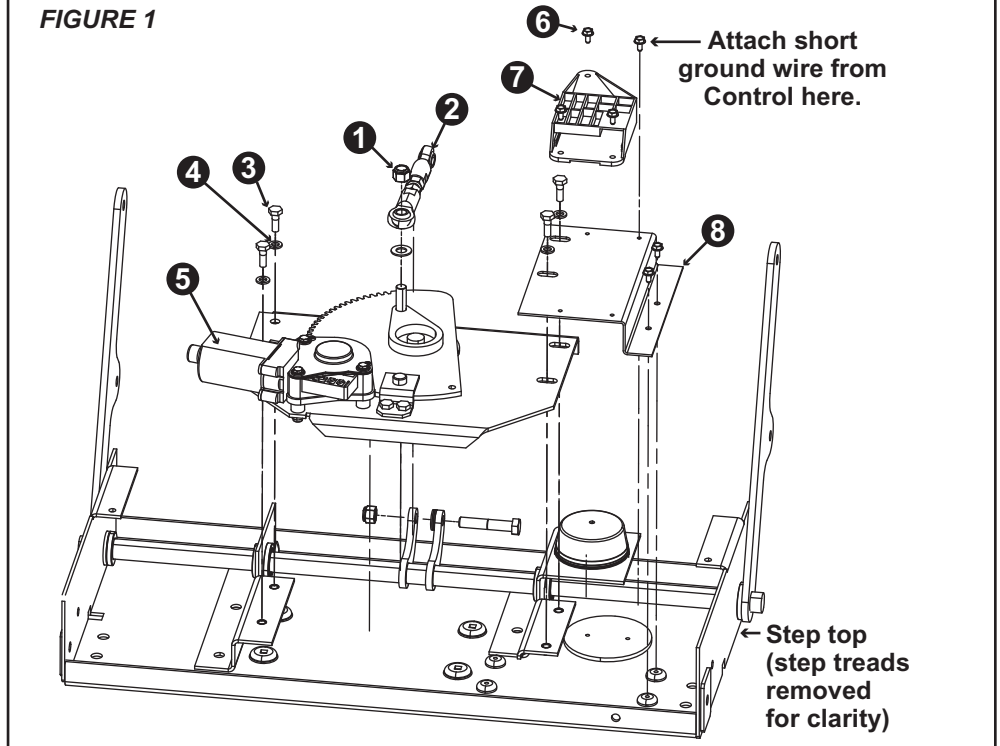

3. Disconnect 12-gage long green ground wire from vehicle chassis.
4. Disconnect short black wire from step light at spade connector. *Note: Not all steps are equipped with an under step light.*
5. If purple wire is used, disconnect or cut wire at the connection.
6. Install control relocation bracket using 2 screws (*Item 6*) and 2 bolts and lock washers (*Items 3 and 4*).
7. Install control on bracket, as shown in *Figure 1*, using 3 screws (*Item 6*).
8. Connect purple wire, if it was used on previous control.
9. Connect black wire spade connector to step light wire.
10. Connect 12-gage long green wire to vehicle chassis using hardware removed in *Step 3*.
11. Connect 4-way Packard connector to coach wiring 4-way Packard connector.
12. Connect short green ground wire, from control, to control relocation bracket (see figure 1 for location) using one screw (*Item 6*).
13. Connect reversing pigtail to motor electrical connector. Connect motor connector from control to pigtail on motor.
14. Reconnect vehicle battery.
15. Test the step functions.